

- 24mm/ 42mm/ 60mm/ 85mm Shaft type
- 42mm/ 60mm/ 85mm Shaft type+Brake built-in type

■ Features

- Compact design and light weight with high accuracy, speed and torque
- Suitable for small-sized equipment applications
- Brake built-in 42mm, 60mm, 85mm of shaft type for compact equipment (AK-B Series)
- Brake force is released (AK-B Series) when applying power on brake wire
- Cost-effective

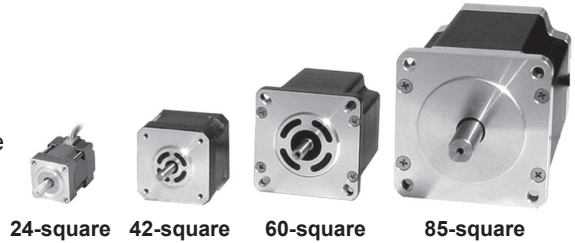

24-square 42-square 60-square 85-square

⚠ Please read "Caution for your safety" in operation manual before using.

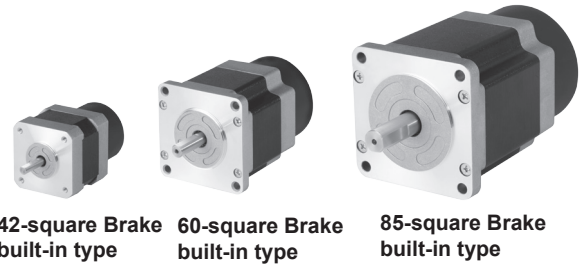

42-square Brake built-in type 60-square Brake built-in type 85-square Brake built-in type

■ Dimensions

◎ 24-square

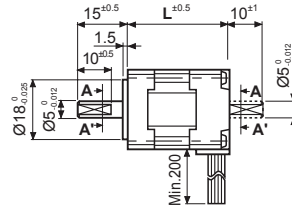
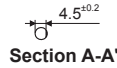
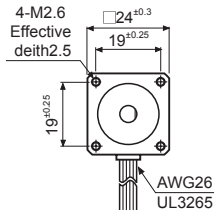

(unit: mm)

| MODEL | L |
|-------------|------|
| 02K-S523(W) | 30.5 |
| 04K-S525(W) | 46.5 |

※ These dimensions are for dual shaft models. In case of single shaft, there is no section A-A' shaft.

◎ 42-square

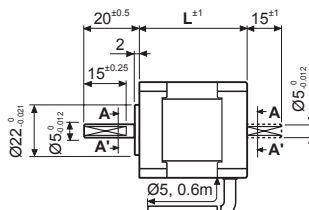
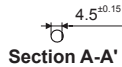
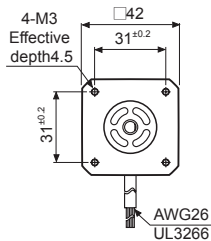

<Standard type>

(unit: mm)

| MODEL | L |
|-------------------|----|
| A1K-S543(W)-[B] | 33 |
| A2K-[]544(W)-[B] | 39 |
| A3K-S545(W)-[B] | 47 |

※ These dimensions are for dual shaft models. In case of single shaft, there is no section A-A' shaft.

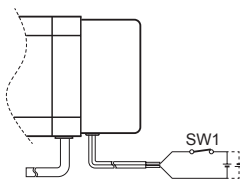

- ※ Brake is non-polar and be sure to observe rated excitation voltage (24VDC).
- ※ SW1 ON-Brake Release / SW1 OFF-Brake Execute

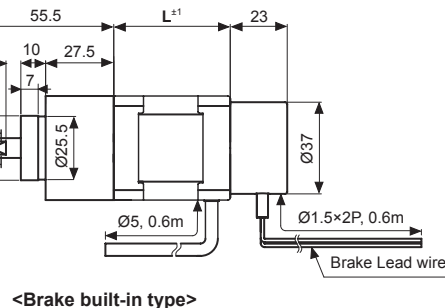

<Brake built-in type>

| | |
|-----|----------------------------------|
| (A) | Photo electric sensor |
| (B) | Fiber optic sensor |
| (C) | Door/Area sensor |
| (D) | Proximity sensor |
| (E) | Pressure sensor |
| (F) | Rotary encoder |
| (G) | Connector/Socket |
| (H) | Temp. controller |
| (I) | SSR/ Power controller |
| (J) | Counter |
| (K) | Timer |
| (L) | Panel meter |
| (M) | Tacho/ Speed/ Pulse meter |
| (N) | Display unit |
| (O) | Sensor controller |
| (P) | Switching mode power supply |
| (Q) | Stepper motor& Driver&Controller |
| (R) | Graphic/ Logic panel |
| (S) | Field network device |
| (T) | Software |
| (U) | Other |

AK/AK-B Series

■ Dimensions

◎ 60-square

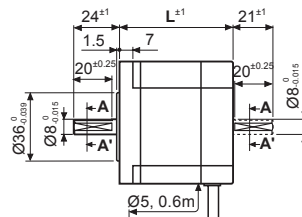
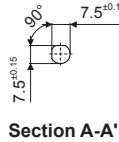
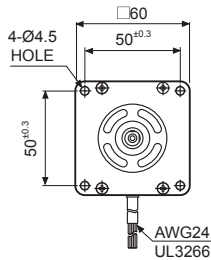

<Standard type>

(unit: mm)

| MODEL | L |
|-----------------|------|
| A4K-□564(W)-□B | 48.5 |
| A8K-□566(W)-□B | 59.5 |
| A16K-□569(W)-□B | 89 |

※ These dimensions are for dual shaft models. In case of single shaft, there is no section A-A' shaft.

※ For flexible coupling (ERB Series) information, refer to F-70 page.

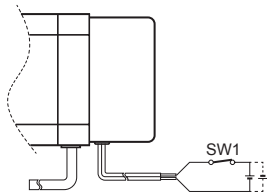

※ Brake is non-polar and be sure to observe rated excitation voltage (24VDC).
 ※ SW1 ON-Brake Release / SW1 OFF-Brake Execute

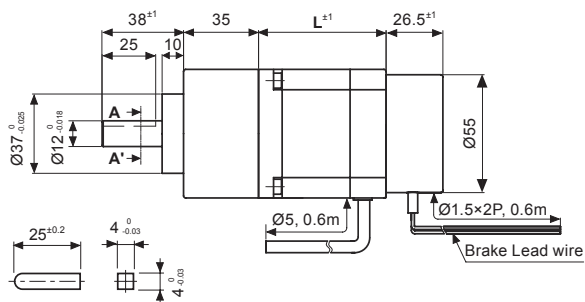

<Brake built-in type>

◎ 85-square

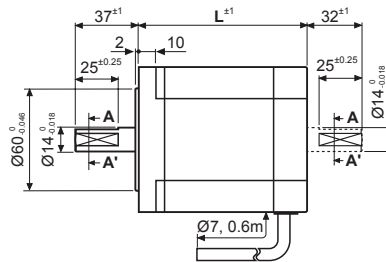
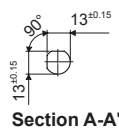
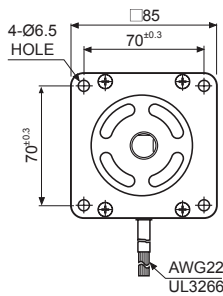

<Standard type>

(unit: mm)

| MODEL | L |
|------------------|-----|
| A21K-□596(W)-□B | 68 |
| A41K-□599(W)-□B | 98 |
| A63K-□5913(W)-□B | 128 |

※ These dimensions are for dual shaft models. In case of single shaft, there is no section A-A' shaft.

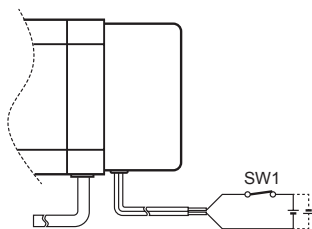

※ Brake is non-polar and be sure to observe rated excitation voltage (24VDC).
 ※ SW1 ON-Brake Release / SW1 OFF-Brake Execute

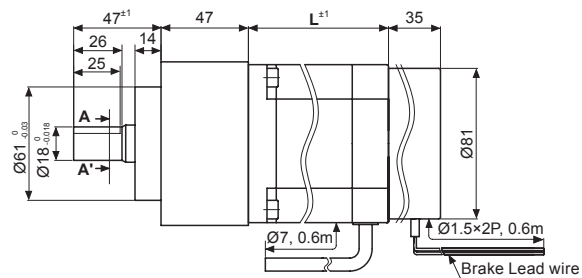

<Brake built-in type>

5-Phase Stepper motor

Characteristic

● 02K-S523

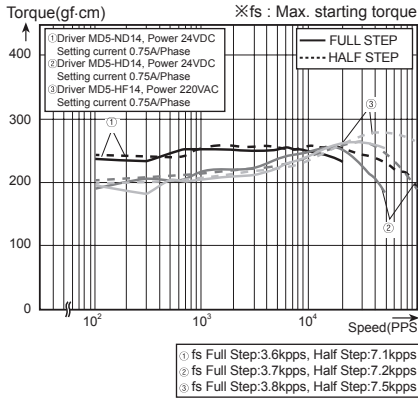

● 04K-S525

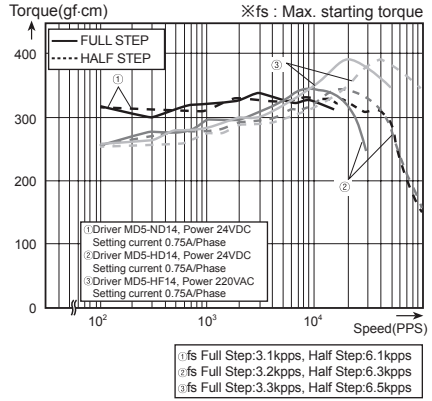

● A1K-S543/A1K-S543-B

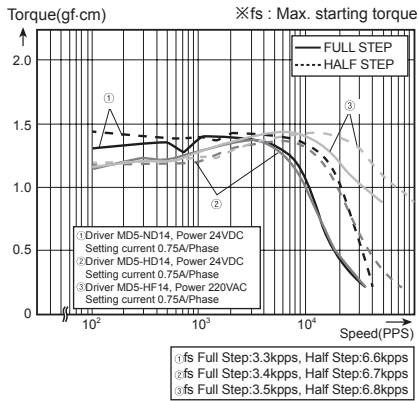

● A2K-S544/A2K-S544-B

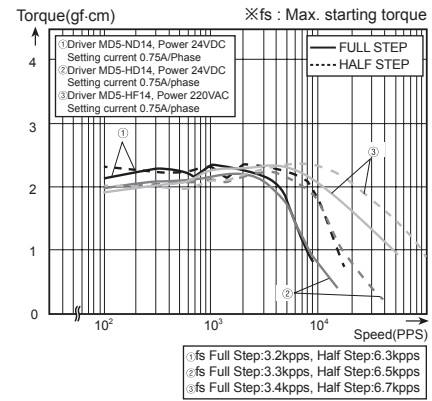

● A3K-S545/A3K-S545-B

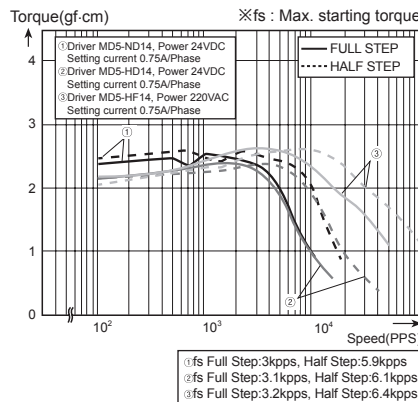

● A4K-M564 / A4K-M564-B

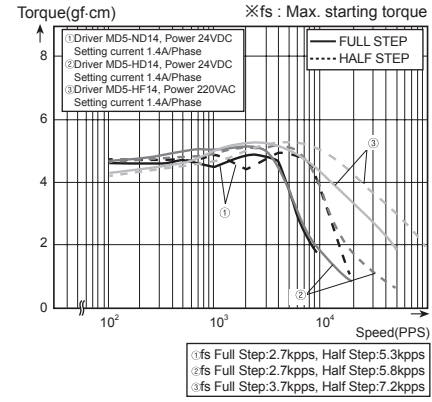

| | |
|-----|----------------------------------|
| (A) | Photo electric sensor |
| (B) | Fiber optic sensor |
| (C) | Door/Area sensor |
| (D) | Proximity sensor |
| (E) | Pressure sensor |
| (F) | Rotary encoder |
| (G) | Connector/Socket |
| (H) | Temp. controller |
| (I) | SSR/ Power controller |
| (J) | Counter |
| (K) | Timer |
| (L) | Panel meter |
| (M) | Tacho/ Speed/ Pulse meter |
| (N) | Display unit |
| (O) | Sensor controller |
| (P) | Switching mode power supply |
| (Q) | Stepper motor& Driver&Controller |
| (R) | Graphic/ Logic panel |
| (S) | Field network device |
| (T) | Software |
| (U) | Other |

AK/AK-B Series

Characteristic

● A8K-M566 / A8K-M566-B

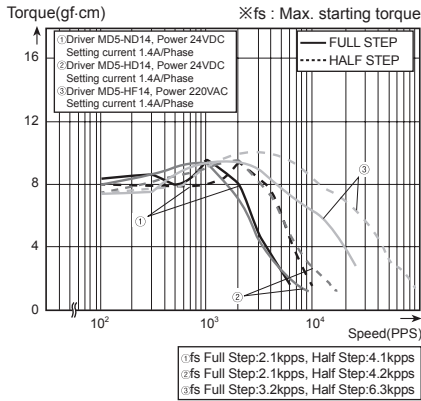

● A16K-569 / A16K-569-B

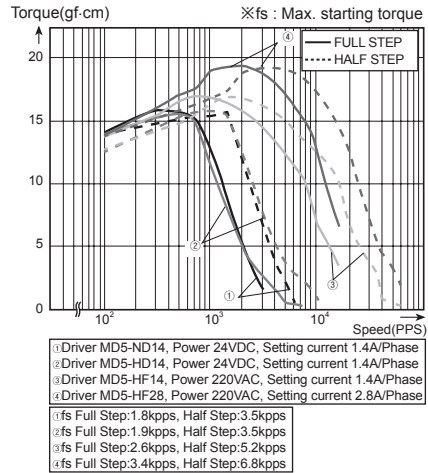

● A21K-596 / A21K-596-B

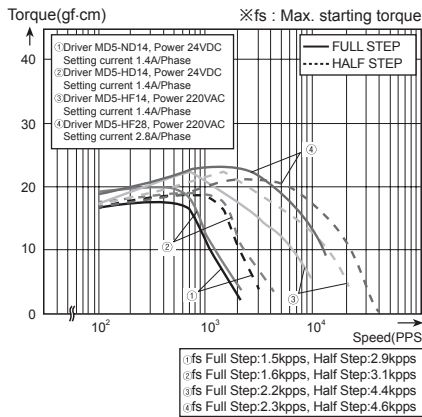

● A41K-599 / A41K-599-B

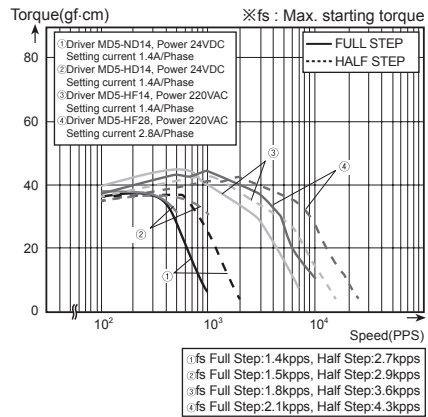

● A63K-5913 / A63K-5913-B

